

ASSURE PRISM MULTI BLOOD GLUCOSE TEST STRIPS

The Assure Prism multi Blood Glucose Monitoring System measures blood glucose quickly and accurately. It automatically absorbs the small blood sample applied to the narrow edge of the strip.

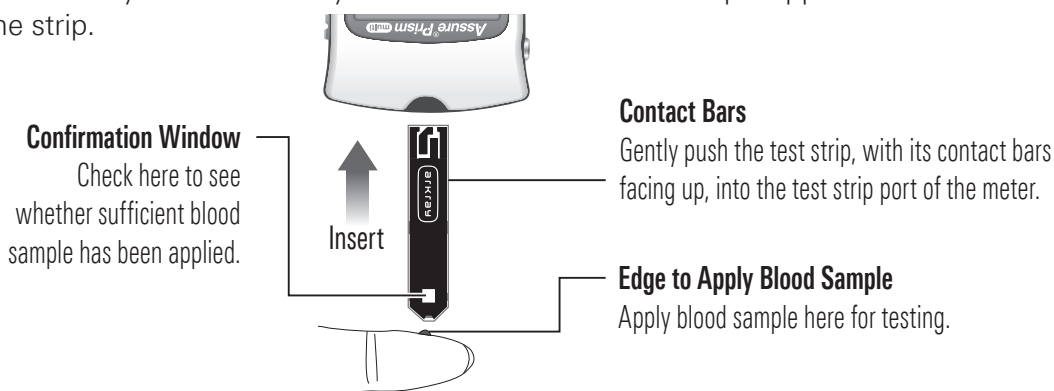

SAFETY INSTRUCTIONS FOR USING TEST STRIPS

- All components that come into contact with blood samples should be considered biohazards capable of transmitting viral diseases between patients and healthcare professionals.
- Assure® Prism multi Blood Glucose Test Strips should be used only with fresh capillary whole blood samples.
- Do not reuse test strips.
- Do not use Assure Prism multi Blood Glucose Test Strips beyond the expiration date as this may cause inaccurate results.
- If the test strips are used and stored according to its storage and handling methods, test strips in new, unopened vials and open vials can be used up until the expiration date printed on the test strip box and vial label.
- Store test strips in a cool and dry place at a temperature of 34–86°F (1–30°C).
- Keep test strips away from direct sunlight or heat and do not freeze.
- Only store test strips in the original vial.
- Close the vial tightly after taking out a test strip and use the test strip immediately.
- Handle test strips with clean and dry hands.
- Do not bend, cut or alter test strips in any way.
- For detailed storage and usage information, refer to the Assure Prism multi Blood Glucose Test Strips package insert.
- Keep the meter and testing supplies away from young children.
- The test strip vial contains drying agents that are harmful if inhaled or swallowed, and may cause skin or eye irritation.

INDIVIDUALLY WRAPPED TEST STRIPS

When using the individually wrapped test strips:

- Check the expiration date on the rear side.
- Tear off the individual wrap on the notch, take the test strip out and use it immediately.

NOTE

- The control solution ranges for the individually wrapped test strips are printed on the test strip box.

Ordering Details		
Product Description	ARKRAY Product Code #	NDC #
Assure Prism multi Blood Glucose Test Strips 50 count	530050	08317-5300-50
Assure Prism multi Blood Glucose Test Strips 100 count	530100	08317-5301-01
Assure Prism multi Blood Glucose Test Strips Foil-wrapped 50 count	532050	08317-5320-50